

# DATA SHEET

Premium Efficiency Motor: **SSPE1.5-18-145TCRD,**

**60 Hz**

WorldWide Electric Corporation

1 (800) 808-2131

Worldwideelectric.net



Document Generated: 9-Nov-2020  
Document ID:

Customer:

## MOTOR INFORMATION

HP	1.5
RPM	1800
Phase	3
Frequency	60
Voltage	230/460
Frame Size	145TC
Enclosure	TEFC
Degree of Protection	IP66
Service Factor	1.15
Poles	4
Full Load Speed	1750
Insulation Class	F
Temp Rise	80°C
NEMA Code Letter	M
Duty Cycle	S1
Slip	2.78%
NEMA Design	B
Moment of Inertia	0.138 lb.ft.^2
Locked Rotor Time (Hot)	12 seconds
Sound Pressure Level	61 dB(A)
Number of Starts	12
Max Ambient Temperature	40° C
Max Elevation	1000 m.a.s.l (3300 f.a.s.l)
Mounting	F1
Rotation	Bidirectional
Area of Classification	Div.2 Class I, Gr. A,B,C&D T2B
Inverter Rating	10:1 CT/20:1 VT
Standard	NEMA MG1, UL1004
Approvals	CSA,UL,CE

## EFFICIENCY/POWER FACTOR

LOAD	EFF	P. F.
100%	86.5 %	0.75
75%	83.0 %	0.61
50%	79.0 %	0.5

## TORQUE

FULL LOAD	LRT	BDT
4.4 lb.ft.	285 %	300 %

## AMPERAGE INFORMATION

	230V	460V
Full Load Amps	4A	2
Locked Rotor Amps	40A	20A
No Load Current	3.3A	1.65A
Usable at 208V	4.1 A	

## BEARING INFORMATION

DE Bearing	6205 2RS
ODE Bearing	6205 2RS
Grease Type	Mobil Polyrex EM
DE Regreasing Interval	-- Hours
ODE Regreasing Interval	-- Hours
Grease Quantity	--

## ADDITIONAL DATA

F2 Suitable	No
Shaft Material	304 Stainless Steel
Connection Diagram	9 Lead 2Y/Y
Approximate Weight	41 lbs.

REVISED 10/21/2020

# MOTOR DRAWING

Premium Efficiency Motor: **SSPE1.5-18-145TCRD**

WorldWide Electric Corporation

1 (800) 808-2131

Worldwideelectric.net

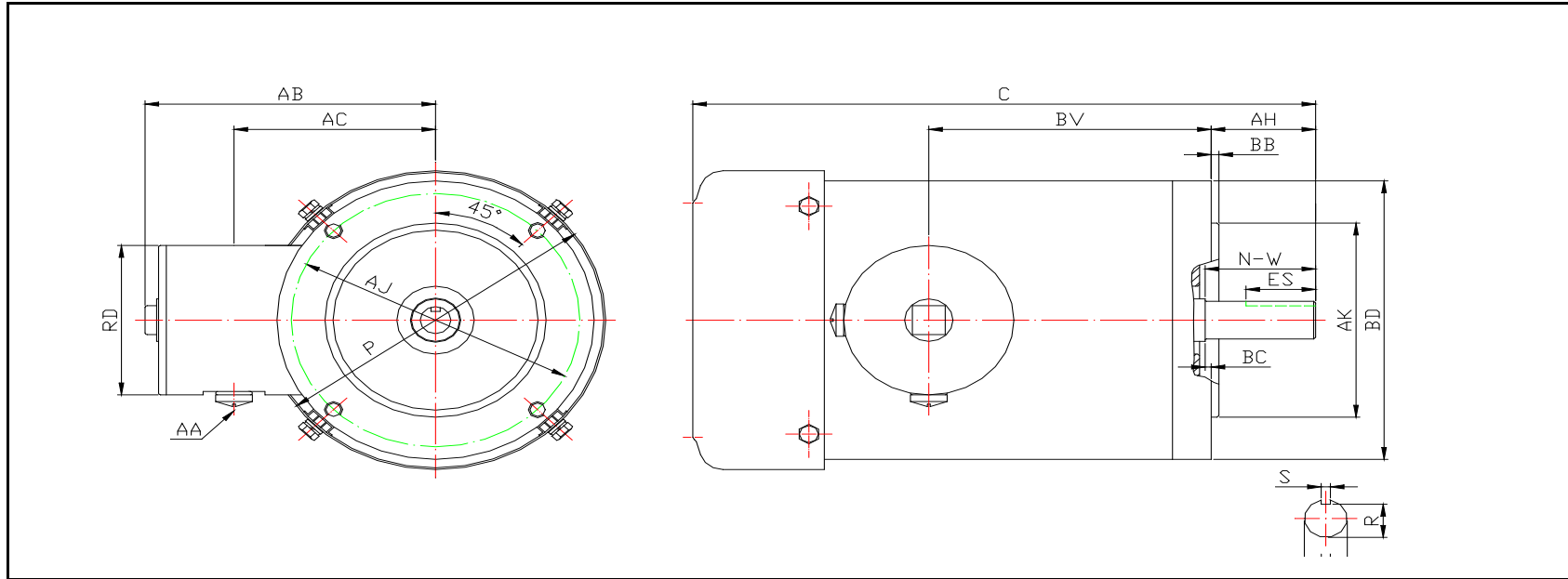

## DIMENSION - INCHES

MOUNTING						A	B	C	D	G	P	O	T
E	2E	2F1	2F2	H	BA								
N/A	N/A	N/A	N/A	N/A	N/A	N/A	N/A	12.63	N/A	N/A	6.95	N/A	N/A

AB	BC	KEY		KEYSET	SHAFT			TERMINAL BOX				
		S	ES	R	AH	N-W	U	AA	AB	AC	RD	BV
5.95	0.12	0.188	1.41	0.771	2.12	1.88	0.875	1/2	5.95	4.5	3.45	4.75

FLANGE				
AJ	AK	BB	BD	BF
5.875	4.5	0.16	6.45	4*3/8-16

REV.	SUMMARY OF MODIFICATIONS	DATE
0		10/21/2020

# PERFORMANCE CURVES

WorldWide Electric Corporation

1 (800) 808-2131

Worldwideelectric.net



Premium Efficiency Motor:

**SSPE1.5-18-145TCRD**

Document Generated: 9-Nov-2020  
Document ID:

Customer:

Motor Type	SSPE				
Output Rating (HP)	1.5	FL Speed	1750		
Full Load Torque	4.4 lb.ft	LRT (%FLT)	285	460 volt FLA	2
Rotor Wk^2	0.138 lb-ft^2	BDT (%FLT)	300	230 volt FLA	4A

SPEED VS TORQUE & CURRENT CURVE

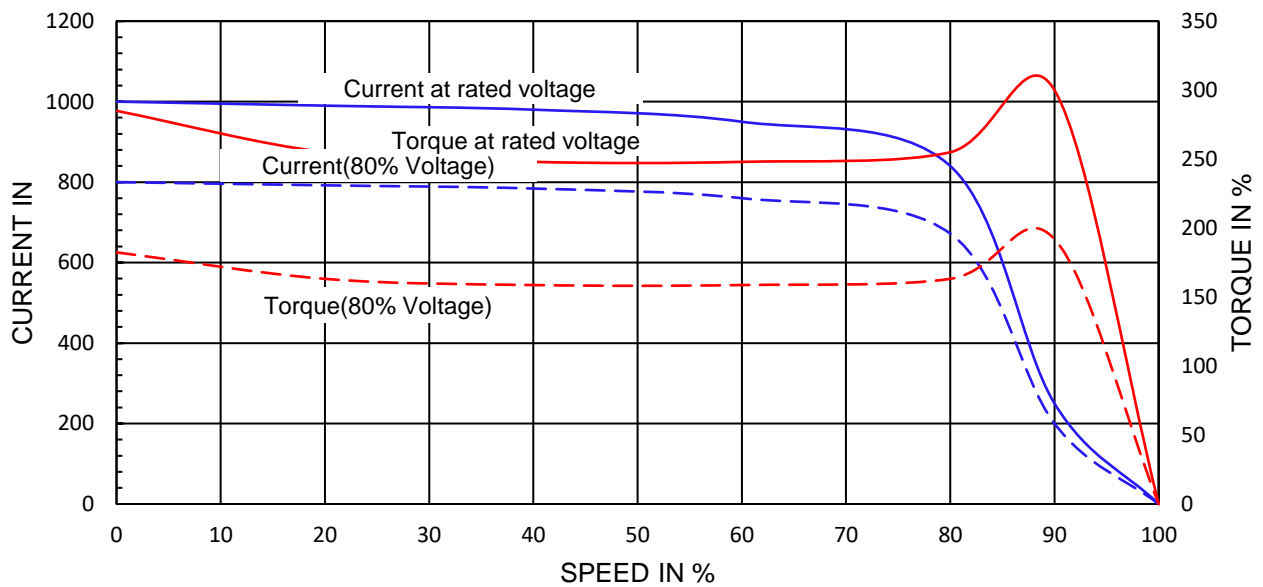

OUTPUT VS EFF., P.F. & CURRENT CURVE

